



JAMES & JAMES
ESTATE AND LETTING AGENTS

t: 01903 958770

e: info@jamesandjamesea.co.uk

119 George V Avenue | Worthing | West Sussex | BN11 5SA

BUYING | SELLING | LETTINGS | MORTGAGE ADVICE



Flat 3 30 Mill Road

Worthing, BN11 5DR

Guide price £190,000



Flat 3 30 Mill Road

Worthing, BN11 5DR

James and James Estate Agents are delighted to offer for sale this fantastic one bedroom, ground floor character apartment in West Worthing. CHAIN FREE

In brief, the accommodation comprises, feature South Facing Bay fronted lounge with high ceilings, Kitchen, large double bedroom and a bathroom.

The property benefits from the use of delightful front and rear communal gardens and an allocated parking space.

The property is in need of a certain amount of refurbishment, in particular in both the bathroom and the kitchen.

The location of this property is so convenient, West Worthing station can be found within a short walk providing access to Brighton, London and beyond. Goring Road shops close by with many coffee shops. Local convenience stores are also situated here. For a more comprehensive shopping experience Worthing Town Centre can be found close by as is the seafront for a leisurely stroll on a warm summers evening.

Communal Entrance Hall

Lounge
17'7 x 15'2 (5.36m x 4.62m)

Kitchen
7'1 x 5'7 (2.16m x 1.70m)

Bedroom
17'1 x 13'2 (5.21m x 4.01m)





Bathroom

Communal Gardens

Allocated Parking Space

Floor Plan

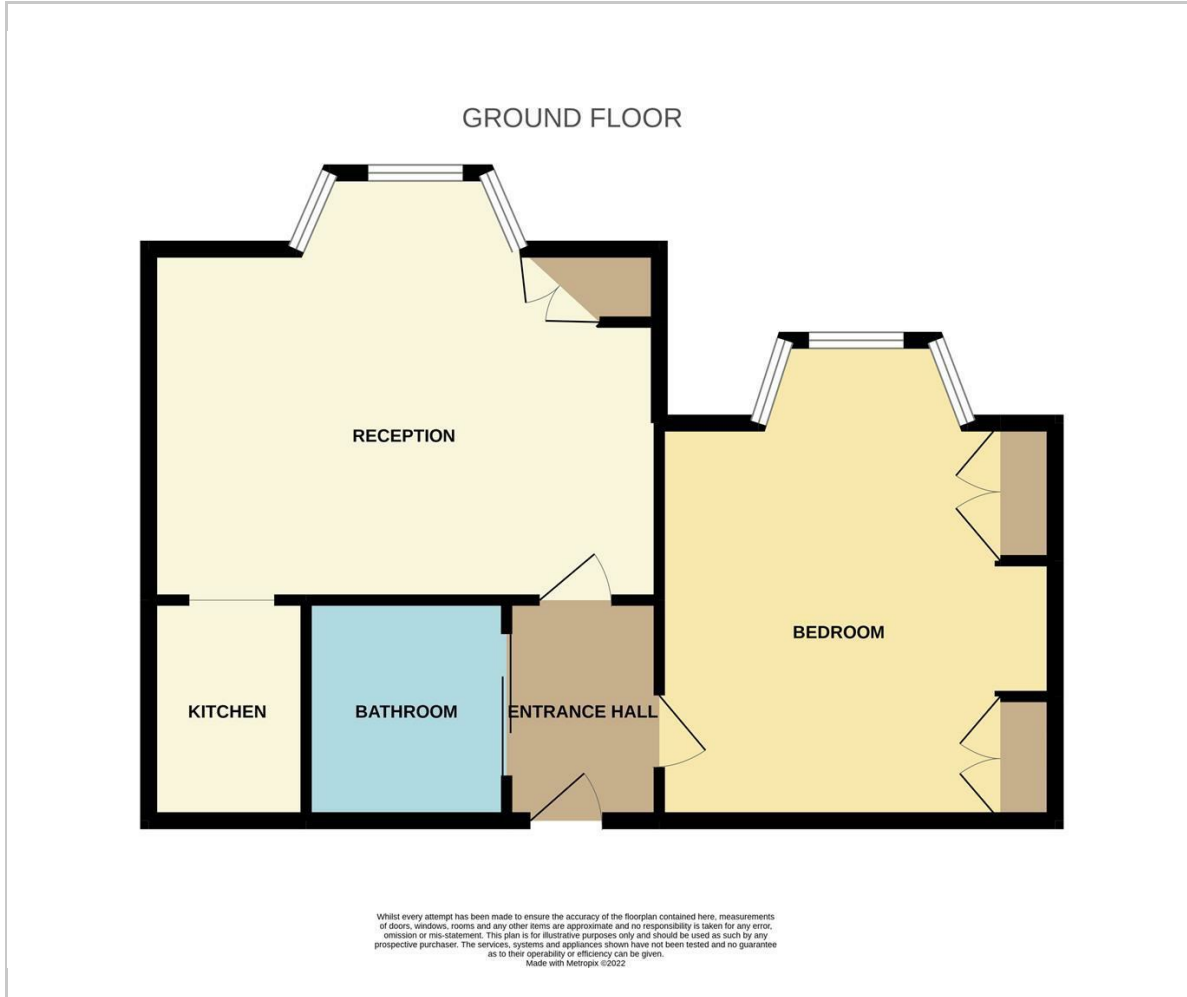

Viewing

Please contact our Worthing Office on 01903 958770 if you wish to arrange a viewing appointment for this property or require further information.

These particulars, whilst believed to be accurate are set out as a general outline only for guidance and do not constitute any part of an offer or contract. Intending purchasers should not rely on them as statements of representation of fact, but must satisfy themselves by inspection or otherwise as to their accuracy. No person in this firm's employment has the authority to make or give any representation or warranty in respect of the property.

Area Map

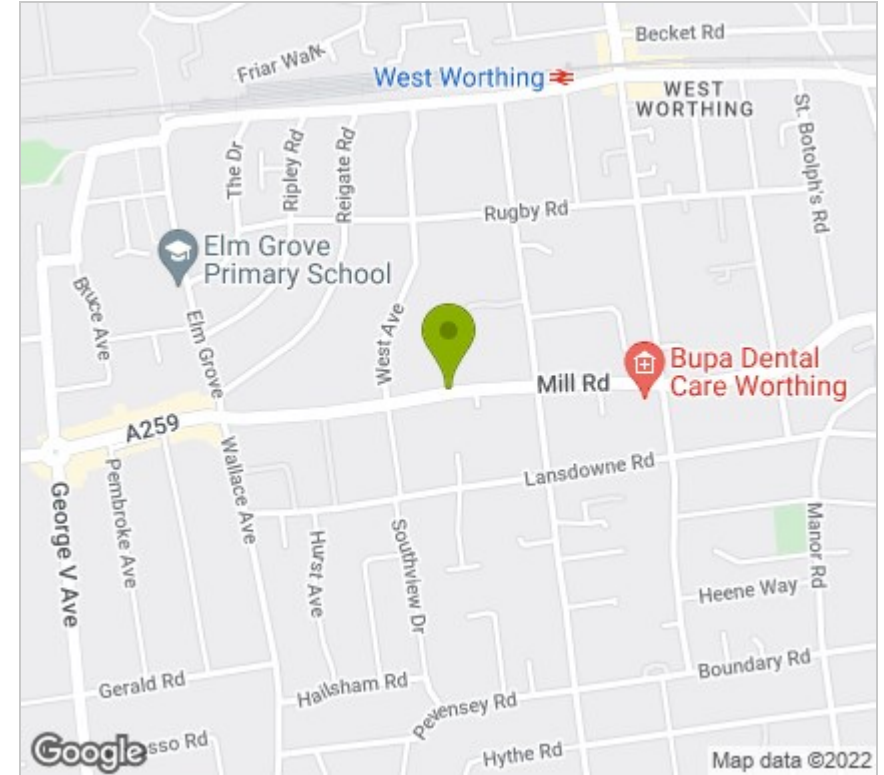

Energy Efficiency Graph

